

# Series L150

## Replaceable Legend Lenses and Filters Pushbutton Lenses Single Lamp/LED

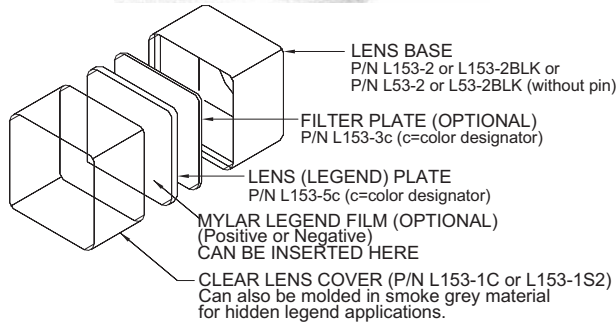

**ELECTRO-MECH**  
COMPONENTS

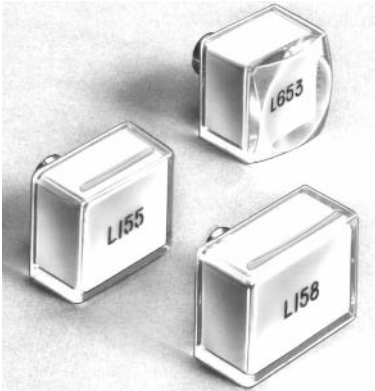

### Applications

Versatile interchangeability with other switch models, choice of color and engravings and non-wearing, clear, acrylic design enables wide-ranging uses of the Electro-Mech Series L150 Replaceable Legend Lens. Lenses may be ordered with a variety of options including clear, frosted or smoke grey top lens cap, and photo positive or negative mylar film legending. Available for most EMC switches.

### Description

Electro-Mech Series L150 Replaceable Legend Lenses are essentially non-wearing, utilizing a GE Lexan™ molded top over cap which protects lens legend. Engravings or films on face of lens display are protected by the lens cover. Opaque sides prevent light spill-over. Filters may be specified in a variety of colors. Legends are replaceable enabling display changes and ultimately broader usage and flexibility of the same basic switch or indicator light across several applications. Translucent lens plate conceals color filter until lamp/LED is illuminated. All lenses accommodate one T 1-3/4 midget flange based lamp or LED. Lenses are removeable from the front panel for re-lamping.

### Part Number Options:

Series L150 lenses may be ordered with the following lens options. Specify desired lens engraving and special requirements when ordering. Special colors are available.

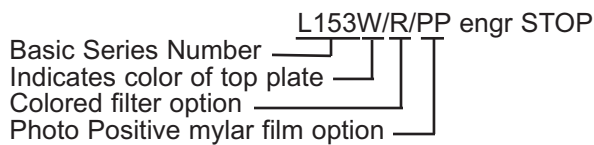

### Ordering Information:

With Locating Pin	Without Locating Pin	Surface Dimension
L153c	L53c	0.74" square
L155c	L55c	0.74" x 0.87"
L157c	L57c	0.74" x 1.49"
L158c	L58c	0.74" x 0.99"
L653c	L1653c	0.74" sq., contour
c=color designation <u>under</u> clear cap (e.g. L153G)		

### Series L150 (not to scale):



**electro-mech**

www.electromechcomp.com

info@electromechcomp.com

1826 Floradale Avenue • South El Monte, CA 91733-3689 USA \* (626) 442-7180 \* (888) 442-7180 \* Fax (626) 350-8070

# Pushbutton Lenses

Solid Colored with Optional Filters  
Flat or Contoured  
Single Lamp or LED



**ELECTRO-MECH**  
COMPONENTS

## Applications

Electro-Mech Components offers standard lenses in a wide variety of sizes, shapes and colors to fit every requirement for its OEM customers. These lenses are designed to accommodate one T 1-3/4 (5mm) midget flange base lamp or LED. Lenses are removeable for relamping from the front panel (specify Series EL for non-removeable flush mounted lenses). Lenses can be supplied with engraved or painted legend lenses. Available lens colors are amber, blue, green, grey, orange, red, white and yellow. Some custom colors are available.

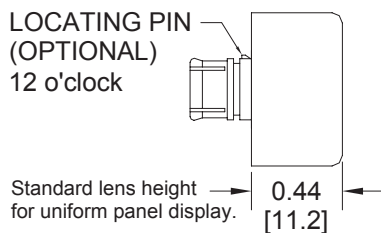
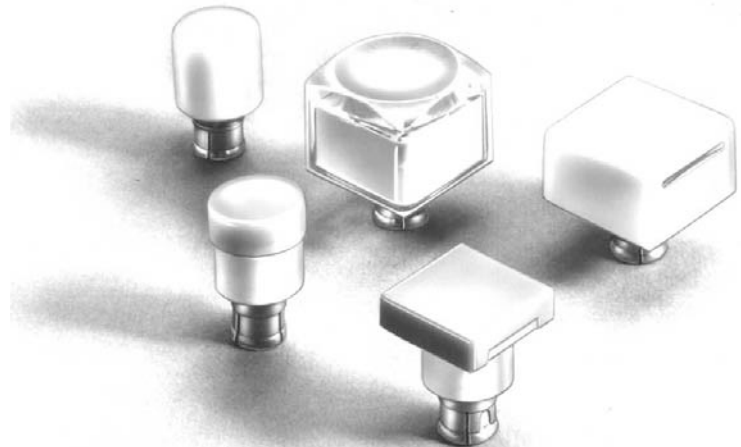

## Part Numbers:

### ROUND

With Locating Pin

L121c  
L122c  
L123c

Without Locating Pin

L21c  
L22c  
L23c

Surface Dimension  
0.49" dia.  
0.62" dia.  
0.74" dia.

### SQUARE

L161c  
L162c  
L163c  
L164c

L61c  
L62c  
L63c  
L64c

0.49" square  
0.62" square  
0.74" square  
0.99" square

### RECTANGULAR

L165c  
L167c  
L169c  
L198c

L65c  
L67c  
L69c  
L98c

0.74" x 0.87"  
0.74" x 1.49"  
0.49" x 0.74"  
0.74" x 0.99"

### CONTOURED

L761c  
L661c  
L662c  
L663c  
L669c

L1761c  
L1661c  
L1662c  
L1663c  
L1669c

0.44"H 0.49" square  
0.56"H 0.49" square  
0.56"H 0.62" square  
0.56"H 0.74" square  
0.56"H 0.49" x 0.74"

c=color designation

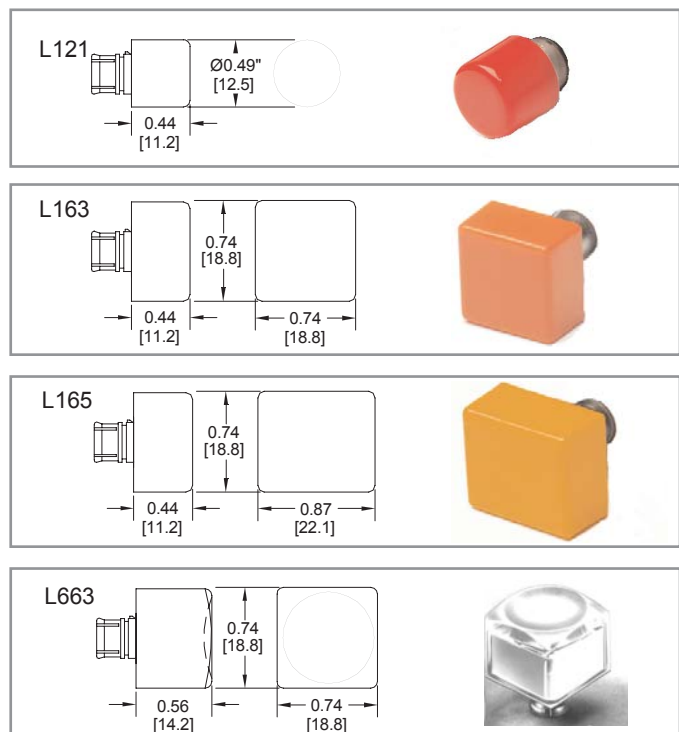

Please contact the factory for additional drawings, specifications, and custom drawings.

**electro-mech**

www.electromechcomp.com

info@electromechcomp.com

1826 Floradale Avenue • South El Monte, CA 91733-3689 USA \* (626) 442-7180 \* (888) 442-7180 \* Fax (626) 350-8070

# Pushbutton Lenses

Single Lamp or LED



**ELECTRO-MECH**  
COMPONENTS



P/N SJ0624,L7163O



P/N SW43611

### Part Numbers:

With Locating Pin	Without Locating Pin	Dimension	Surface Height	Shape / Description
L221c	L1221c	0.49" dia.	0.37	Round
L261c	L1261c	0.49" sq.	0.56	Square
L263c	L1263c	0.74" sq.	0.62	Square
L362c	L1362c	0.62" sq.	0.28	Square
L553c	L1553c	0.74" sq.	0.56	Clear contoured cap over 0.62" sq. lens
L561c	L1561c	0.49" sq.	0.44	Square, opaque sides
L562c	L1562c	0.62" sq.	0.44	Square, opaque sides
L563c	L1563c	0.74" sq.	0.44	Square, opaque sides
L569c	L1569c	0.49" x 0.74"	0.44	Rect., opaque sides
L320		0.33" dia.	0.17	Round
	L611c	0.49" sq.		Series 20 only
	L612c	0.49" dia.		Series 20 only
	L613c	0.62" sq.		Series 20 only
	L614c	0.62" dia.		Series 20 only
	L615c	0.74" sq.		Series 20 only
	L616c	0.74" dia.		Series 20 only
	L619c	0.49" x 0.74"		Series 20 only

c=color designation

### Lens Colors:

Color	Code	Std. Mat'l	Material No.	Filters
Amber	A	Tenite	516A6T024	W/A
Blue	B	Lexan	141-2204	W/B
Black	BLK	Lexan	940-701	OPAQUE
Green	G	Lexan	940P-GN5018X	W/G
Green, Dark	G(DK)	Lexan	141-3205	W/G(DK)
Grey	GRY	Lexan	141P-GY6023X	
Orange	O	Lexan	940-6213	W/O
Red	R	Lexan	940P-RD3057	W/R
White	W	Lexan	141-9204	
Yellow	Y	Lexan	141-4223 ("school bus")	W/Y
Yellow, Bright	Y(Brt)	Lexan	940-YW7103X	

### Modification Codes:

Code	Description
AM	RFI filter internally (e.g. L63R-AM)
FG	Fingernail Grooves, 12 o'clock and 6 o'clock standard (e.g. L63R-FG)
FG39	Fingernail Grooves at 3 & 9 o'clock
FG4	Fingernail Grooves on all four sides
L7xxx	Modified lens insert for PD (Pollak/Pendar) style switch plunger (long)
L9xxx	Modified lens insert for PD (Pollak/Pendar) style switch plunger (short)
OS	Opaque sides on lens (standard on Series L150)
W	Water-resistant (e.g. WL163W) (includes rubber o-ring on lens insert)

### Pendar (PD) Style Lenses

#### L7XXX

Long lens  
Insert fits  
PD style  
switch plunger

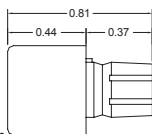

#### L9XXX

Short lens  
Insert fits  
PD style  
switch plunger

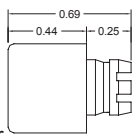

**electro-mech**

www.electromechcomp.com

info@electromechcomp.com

1826 Floradale Avenue • South El Monte, CA 91733-3689 USA \* (626) 442-7180 \* (888) 442-7180 \* Fax (626) 350-8070

# Pushbutton Lenses

## Single Lamp or LED

Engraved Legends ○ Silk Screened Legends

Hidden Legends ○ Photo Positive & Negative Film Legends



**ELECTRO-MECH**  
COMPONENTS

### Lens Legend Engraving:

Lens Surface	Width of Surface	Character Style					
		Regular Block			Condensed Block		
		Height of Chars. 0.125	0.187	0.250	Height of Chars. 0.125	0.187	0.250
		Number of Characters/Line			Number of Characters/Line		
Round	0.50	3	2	1	4	3	2
Round	0.63	4	2	1	6	3	2
Round	0.75	5	3	2	7	4	4
Square or Rectangular	0.50	3	2	1	5	3	2
Square or Rectangular	0.63	5	3	2	6	4	3
Square or Rectangular	0.75	5	3	2	8	4	3
Square or Rectangular	0.88	6	4	3	9	5	4
Square or Rectangular	1.00	8	5	3	10	7	4
Square or Rectangular	1.50	12	8	5	16	10	8
Stroke of Character:		0.012	0.020	0.025	0.012	0.020	0.025
Spacing Between Lines:	2 lines:	0.125 standard					
	3 lines:	0.063 standard					
	4 lines:	0.032 standard					
Color of Fill:	Black is standard color fill. White fill available. White fill recommended for blue (B) and dark green (G(DK)) lenses. Order as "ENGR STOP (white fill)."						
Pin Orientation:	Anti-rotation pin orientation is at 12 o'clock standard relative to the lens engraving.						
Fingernail Grooves:	Standard location is at 6 and 12 o'clock relative to the lens engraving. For FG grooves on the sides, specify FG39 (e.g. WL163W-FG39).						

### Lens Ordering Information:

	<b>W</b>	<b>L163</b>	<b>W</b>	<b>(L)</b>	<b>/R</b>	<b>- FG, D327 engr</b>	<b>POWER</b>
Waterproof O-Ring (optional)	Line	Line	Line	Line	Line	Line	Line
2-4 digit lens part number	Line	Line	Line	Line	Line	Line	Line
Lens color	Line	Line	Line	Line	Line	Line	Line
Specifies custom material (optional)	Line	Line	Line	Line	Line	Line	Line
Filter color (optional)	Line	Line	Line	Line	Line	Line	Line
Fingernail groove (optional)	Line	Line	Line	Line	Line	Line	Line
Lamp or LED (optional)	Line	Line	Line	Line	Line	Line	Line
Lens legend (optional)	Line	Line	Line	Line	Line	Line	Line
Other Options:							
/PP = Photo positive mylar film (for Series L150 lenses)							
/PN = Photo negative mylar film (for Series L150 lenses)							
Please call the factory for custom lenses and display options and capabilities.							

**electro-mech**

www.electromechcomp.com

info@electromechcomp.com

1826 Floradale Avenue • South El Monte, CA 91733-3689 USA \* (626) 442-7180 \* (888) 442-7180 \* Fax (626) 350-8070